

# L1451

## 安装之前 Before installation

所有的资料是随最新的产品资料编写而成。  
 韦乐洁具有限公司保留任何权利不经通知即可改变产品  
 特性,包括此产品的供货类型的权利。  
 说明书包括重要的安装,保养及清洁方面的内容,  
 请仔细阅读并妥善保管。

注意事项:  
 1. 安装前请仔细清洗供水管道中的杂质。  
 2. 检查供水管有无损坏,如有,请及时更换。  
 3. 遵守当地管路安装系统。

All information is based on the latest product information.  
 Weyle sanitary ware Co., Ltd reserves the right to change  
 the product features, packaging or type of offering without  
 notice at any time.

Instructions include important installation, maintenance and  
 cleaning aspects. Please submit these information to the user  
 for reading.

NOTES:  
 1. Flush the water supply pipes thoroughly to remove debris.  
 2. Inspect the supply pipes to be broken or not. If necessary,  
 please replace it.  
 3. Comply local plumbing codes.

## 产品包装部件 Product packaging spare parts

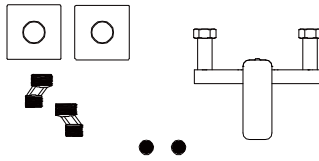

## 安装步骤 Installation steps

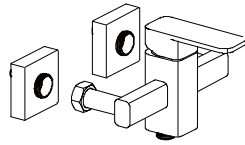
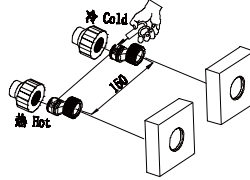

## 安装尺寸 Installation dimension

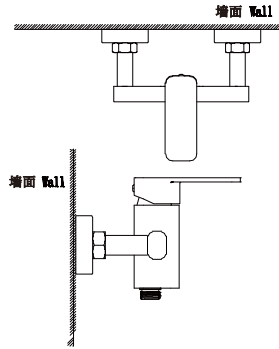

## 使用说明 Instructions

开关龙头及冷热水操作如下图所示 Faucet Switch and cold and hot water operation are shown below.

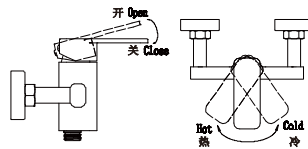

## 零件图 Part drawing

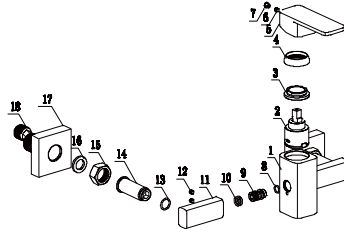

序号	名称	序号	名称	Number	Name	Number	Name
1	主体	10	密封圈	1	Faucet body	10	Seal ring
2	开关阀芯	11	主体	2	Switch cartridge	11	Faucet body
3	压帽	12	锁紧螺丝	3	Pressing cap	12	screw
4	装饰盖	13	密封圈	4	Decoration cover	13	Seal ring
5	手柄	14	进水接头	5	handle	14	water inlet joints
6	锁紧螺丝	15	螺帽	6	screw	15	Screw Nuts
7	装饰点	16	滤网垫片	7	Decorative point	16	Rubber Gasket With Mesh
8	O型圈	17	装饰罩	8	O-ring	17	Decoration cover
9	出水接头	18	接头	9	water outlet joint	18	Joints